

8P025600

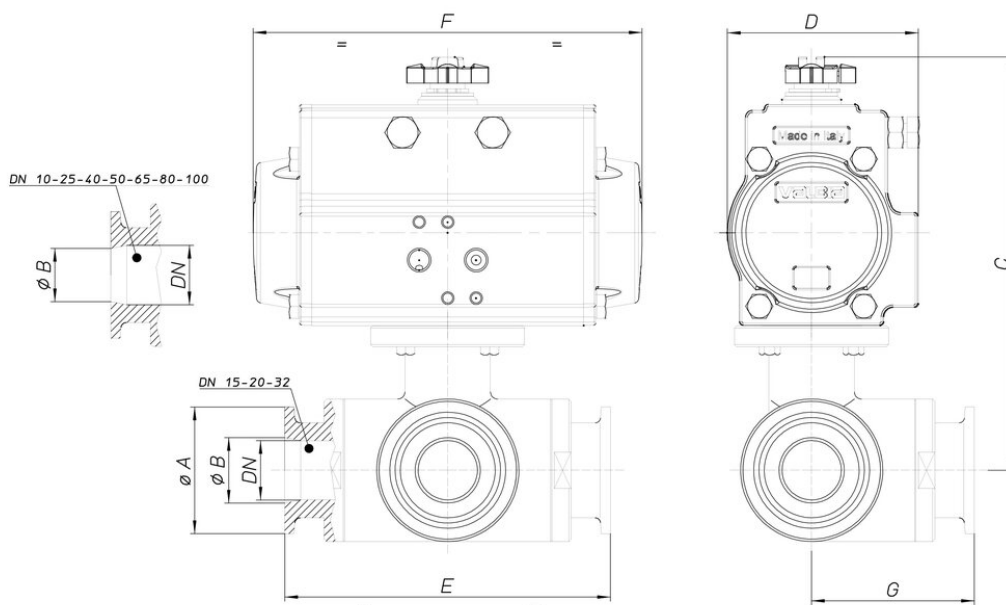

3 way ball valve, from ingot, AISI 316, clamp connections ISO 2852, DIN 32676 TABLE 4 REIHE C for tube BS/OD (ASTM A270), 4 P.T.F.E. seals, polished, full bore or reduced bore, "T" or "L" port.

Technische Spezifikationen



| MOD | PN | ØA | ØB | C | D | E | F | G | ACT. |
|------------|-----------|-----------|-----------|----------|----------|----------|----------|----------|-------------|
| 8P02560003 | 40 | 25 | 9,7 | 148 | 71 | 108 | 141 | 54 | DA 52 |
| 8P02560004 | 40 | 25 | 16 | 151 | 71 | 118 | 141 | 59 | DA 52 |
| 8P02560005 | 40 | 51 | 22,2 | 170 | 81 | 130 | 164 | 65 | DA 63 |
| 8P02560007 | 40 | 51 | 34,8 | 195 | 81 | 156 | 164 | 78 | DA 63 |
| 8P02560010 | 25 | 64 | 47,5 | 237 | 106 | 182 | 241 | 91 | DA 85 |
| 8P02560012 | 25 | 78 | 60,2 | 247 | 106 | 196 | 241 | 98 | DA 85 |
| 8P02560014 | 16 | 91 | 72,6 | 274 | 123 | 256 | 275 | 128 | DA 100 |
| 8P02560018 | 16 | 119 | 97,6 | 289 | 123 | 286 | 275 | 143 | DA 100 |